

**Product Name:**

## XTherm Blue

**Description:**

XTherm Blue is a premium product for the insulation of timber-framed, steel-framed and masonry buildings. XTherm Blue is a high-performance, extruded, closed-cell rigid foam board insulation with high compressive strength

**Typical Uses:**

- Insulated overlay to masonry buildings
- Insulated substrate over timber/steel framed buildings

**Expectation:**

The unique structure of extruded styrene (XPS) creates rigidity. An inert, rigid foam product does not settle, or take up moisture over time, thus ensuring the Thermal performance or R-value for the life of the building. It is impervious to water-related damage and deterioration, making it the perfect material for areas that are damp on a regular basis.

**Technical Data:**

Typical thicknesses:	50mm
Board density:	34 kg/m <sup>3</sup>
Thermal Conductivity:	0.0303 W/mK (Average 23°)
Thermal Resistance R-Value :	50mm - R1.65 (m <sup>2</sup> K/W)
Compressive Strength:	288KPa
Moisture Permeability:	1.8 Ng/(msPa) (23°, RH50%)
Water Absorption:	0.6% (96 hours)
Dimension Stability (L,W,T):	1.5% (70°, 48hours)
Fire:	Complies with AS 2122.1-1993

**Surface Preparation:**

If the substrate has been left exposed to UV / sunlight for more than two weeks, dust and dirt may build up on the surface, the surface may also discolour (yellow) you must remove all surface dust, oxidisation, and other contaminants. Use a rasp or a stiff broom to prepare the substrate

**Application:**

Check using a straight edge to ensure the wall is flat, plumb and true. Any irregularities should be taken out by straightening using a rasp.

The Render coating is not designed to straighten deviations that exceed the specified Resene Construction Systems Render System thickness.

**Environmental and Safety:**

Ensure styrene does not enter waterways. Contain in bags to ensure loose material is not blown away. There are currently many locations around the country that provide access to recycling services. Many of these recycling providers also offer to pick up and drop off services, to ensure you can recycle hassle-free. They are also committed to environmentally sound recycling processes and ensuring that styrenes can be recycled and reused many times over. XTHERM Blue is 96% air.

**Typical coating configuration**

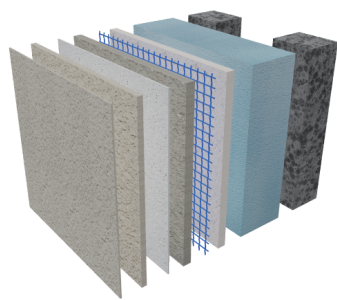

Timber/Steel framing

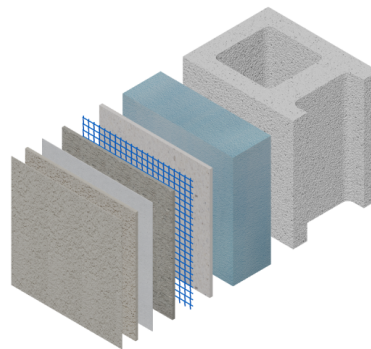

Masonry overlay